



10+00

15+00

WASHINGTON CENTER ROAD

**BEGIN PROJECT**  
 P.O.T. Sta. 10+52.72 LINE 'PR-W' =  
 O.P.O.T. STA. 10+52.72 LINE 'W', 1.76' RT.

LINE 'PR-SB'

LINE 'PR-A'

**LEGEND**

- 53 Line, Thermoplastic, Solid, White, 4"
- 54 Line, Thermoplastic, Broken, White, 4"
- 55 Line, Thermoplastic, Solid, Yellow, 4"
- 56 Line, Thermoplastic, Broken, Yellow, 4"
- 57 Transverse Marking, Thermoplastic, Stop Line, 24 in.
- 58 Line, Thermoplastic, Solid, Yellow, 8"
- 59 Line, Thermoplastic, Solid, White, 8"
- 61 Line, Thermoplastic, Solid, White, 12"
- Sign
- Pavement Message Marking, Thermoplastic, Lane Indication Arrow

Note:  
 All Stationing Is Relative To Line 'PR-W'

Date: Oct 22, 2015, 3:27pm User ID: eboyd  
 File: M:\Proj\1466\2107\Phase 1\Civil\Drawg\SIGNS-PM\2107PM01.dwg Model Tab: WC PM



**NOT FOR CONSTRUCTION**  
 DLZ INDIANA, LLC

RECOMMENDED FOR APPROVAL _____	DESIGN ENGINEER _____	DATE _____
DESIGNED: PSL	DRAWN: DJM	
CHECKED: JRN	CHECKED: JRN	

**CITY OF FORT WAYNE**  
**ST. JOSEPH CENTER ROAD REHABILITATION**  
**SIGNING AND PAVEMENT MARKING**  
**WASHINGTON CENTER ROAD**

HORIZONTAL SCALE 1"=40'	ROAD FILE
VERTICAL SCALE 1"=40'	DESIGNATION 0710322
SURVEY BOOK ELECTRONIC	SHEETS 36 of 74
CONTRACT R-30443	PROJECT 0710322

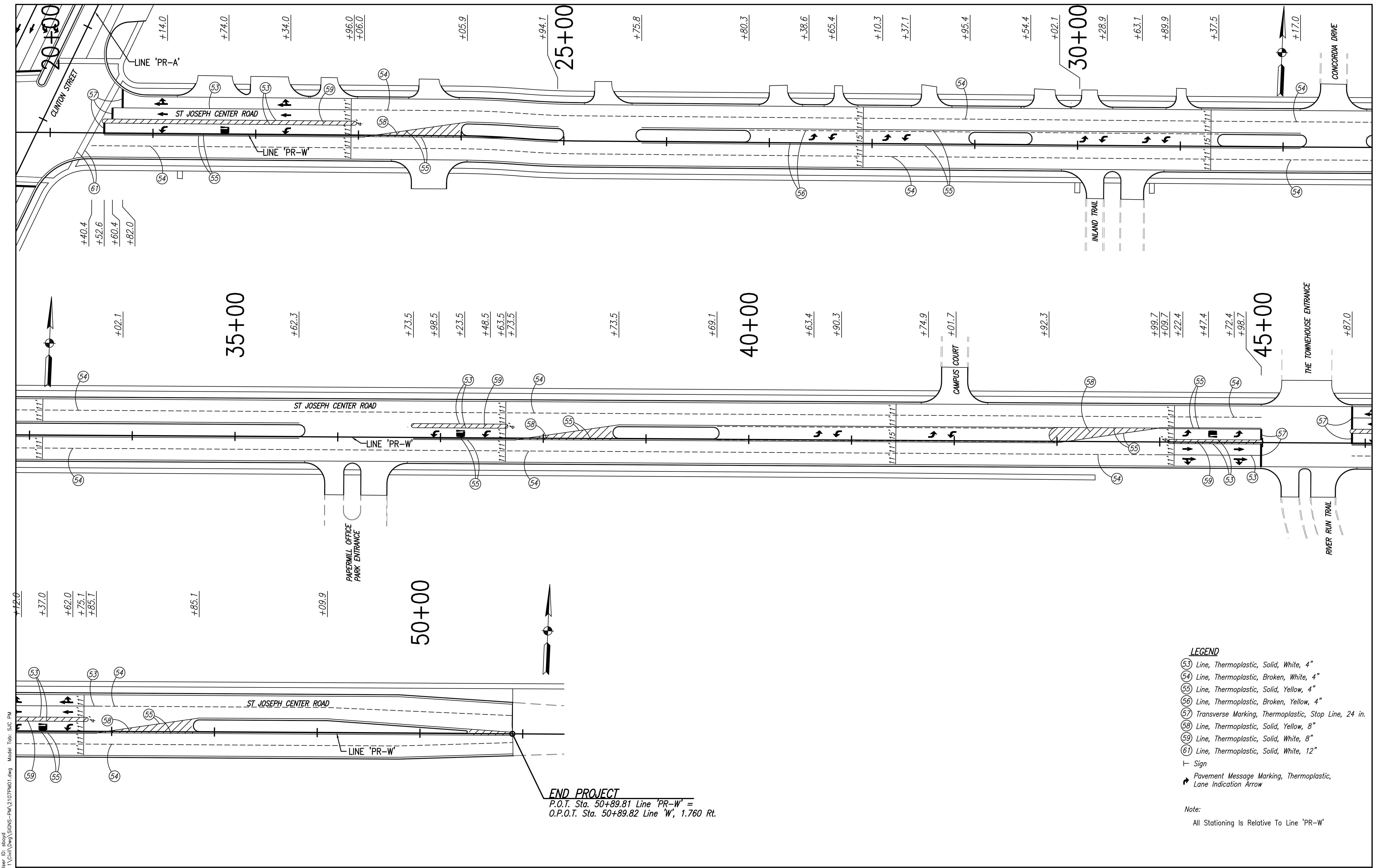

**END PROJECT**  
 P.O.T. Sta. 50+89.81 Line 'PR-W' =  
 O.P.O.T. Sta. 50+89.82 Line 'W', 1.760 Rt.

- LEGEND**
- (53) Line, Thermoplastic, Solid, White, 4"
  - (54) Line, Thermoplastic, Broken, White, 4"
  - (55) Line, Thermoplastic, Solid, Yellow, 4"
  - (56) Line, Thermoplastic, Broken, Yellow, 4"
  - (57) Transverse Marking, Thermoplastic, Stop Line, 24 in.
  - (58) Line, Thermoplastic, Solid, Yellow, 8"
  - (59) Line, Thermoplastic, Solid, White, 8"
  - (61) Line, Thermoplastic, Solid, White, 12"
  - ┌ Sign
  - ▬ Pavement Message Marking, Thermoplastic, Lane Indication Arrow

Note:  
 All Stationing Is Relative To Line 'PR-W'

Date: Oct 22, 2015 3:28pm User ID: eboyd  
 File: M:\Proj\1486\2107\Phase 1\Civil\Draw\SIGNS-PA\2107PM01.dwg Model Tab: SJC PM

	<b>NOT FOR CONSTRUCTION</b> <small>DLZ INDIANA, LLC</small>	RECOMMENDED FOR APPROVAL _____ DESIGN ENGINEER _____ DATE _____	<b>CITY OF FORT WAYNE</b> <b>ST. JOSEPH CENTER ROAD REHABILITATION</b>  <b>SIGNING AND PAVEMENT MARKING</b> <b>ST. JOSEPH CENTER ROAD</b>	HORIZONTAL SCALE 1"=40' ROAD FILE _____
		DESIGNED: PSL DRAWN: DJM CHECKED: JRN CHECKED: JRN		VERTICAL SCALE 1"=40' DESIGNATION 0710322
				SURVEY BOOK ELECTRONIC SHEETS 37 of 74 CONTRACT PROJECT R-30443 0710322

Date: Oct 22, 2015, 3:28pm User: ID: eboyd  
 File: M:\Proj\1466\2107\Phase 1\Civil\Drawg\SIGNS-PA\2107PM01.dwg Model Tab: CS PM

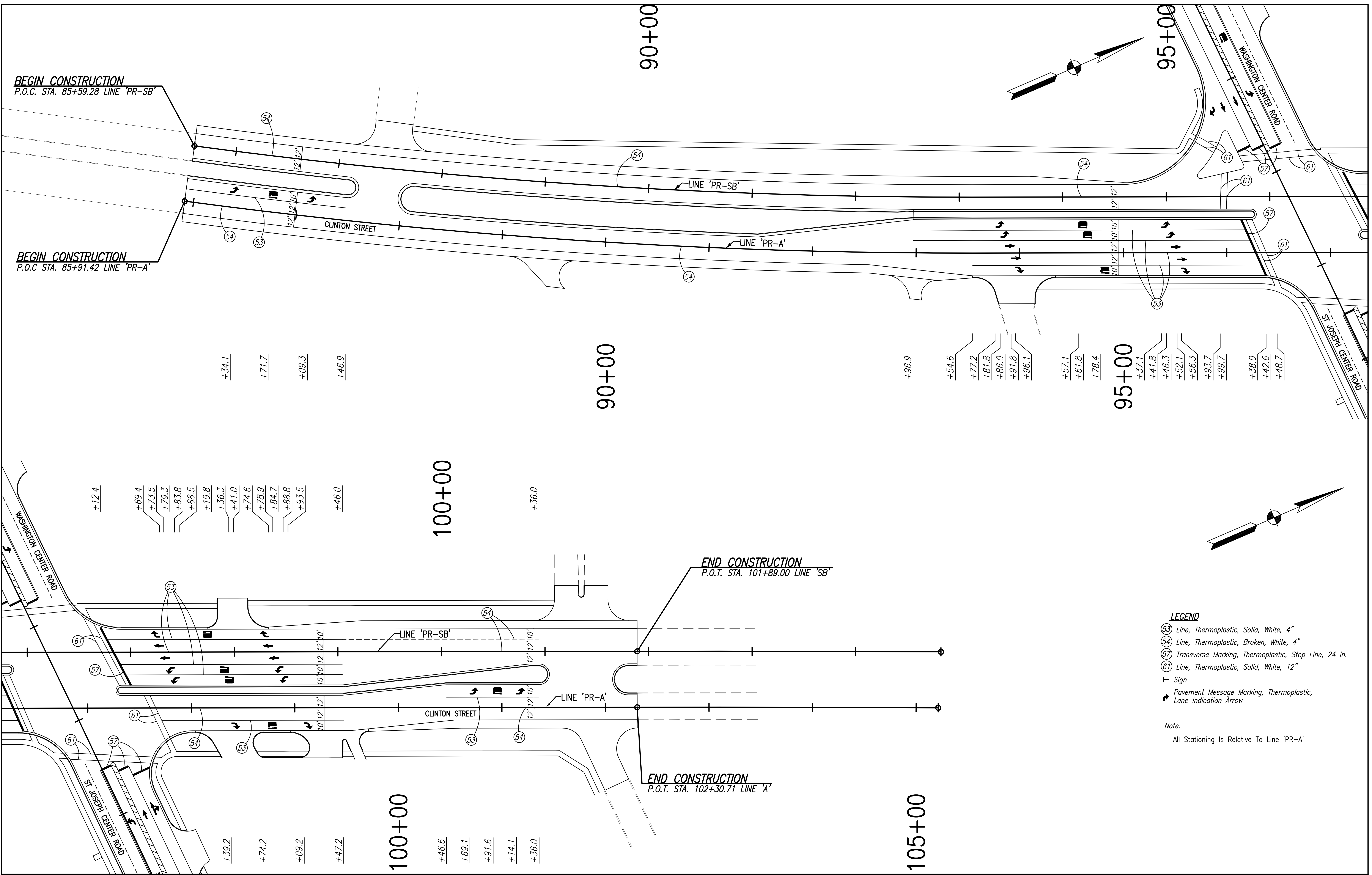

- LEGEND**
- (53) Line, Thermoplastic, Solid, White, 4"
  - (54) Line, Thermoplastic, Broken, White, 4"
  - (57) Transverse Marking, Thermoplastic, Stop Line, 24 in.
  - (61) Line, Thermoplastic, Solid, White, 12"
  - Sign
  - Pavement Message Marking, Thermoplastic, Lane Indication Arrow

Note:  
All Stationing Is Relative To Line 'PR-A'



**NOT FOR CONSTRUCTION**  
 DLZ INDIANA, LLC

RECOMMENDED FOR APPROVAL _____	DESIGN ENGINEER _____	DATE _____
DESIGNED: PSL	DRAWN: DJM	
CHECKED: JRN	CHECKED: JRN	

**CITY OF FORT WAYNE**  
**ST. JOSEPH CENTER ROAD REHABILITATION**  
**SIGNING AND PAVEMENT MARKING**  
**CLINTON STREET**

HORIZONTAL SCALE 1"=40'	ROAD FILE
VERTICAL SCALE 1"=40'	DESIGNATION 0710322
SURVEY BOOK ELECTRONIC	SHEETS 38 of 74
CONTRACT R-30443	PROJECT 0710322